

Ground Floor
Approx. 196.0 sq. metres (2169.9 sq. feet)

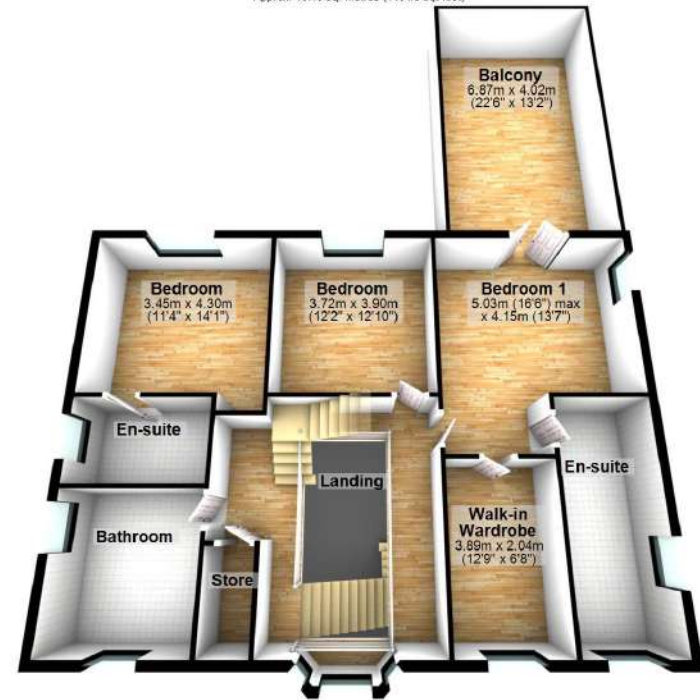

First Floor
Approx. 107.3 sq. metres (1154.5 sq. feet)



Second Floor
Approx. 80.7 sq. metres (863.0 sq. feet)



Total area: approx. 363.9 sq. metres (3917.4 sq. feet)