

# Finest

[finest.co.uk](http://finest.co.uk)

Whitfield | Hexham | Northumberland

West Steel



# “A South-Facing Farmhouse with Equestrian Facilities and 9.79 Acres”

## The Property

Occupying an enviable south-facing position within the North Pennine landscape, West Steel is a substantial stone-built farmhouse set within approximately 9.79 acres of gardens, grazing land and woodland. Enjoying far-reaching views across the surrounding countryside, the property combines the character of a traditional farmhouse with practical equestrian facilities, extensive outbuildings and a thoughtful programme of modern improvements.

Approached via a private shared driveway, the house immediately conveys a sense of space and privacy. The elevated position allows the surrounding landscape to become an integral part of everyday life, with almost every room enjoying an attractive outlook across the gardens, paddocks or rolling countryside beyond.

Internally, the accommodation extends to almost 2,900 sq ft and has been carefully updated by the current owners whilst retaining the warmth and character expected of a rural farmhouse.

The sitting room is positioned to take full advantage of the property's south-facing aspect, enjoying far-reaching views across the surrounding countryside through a large picture window. Exposed ceiling beams lend character overhead, while an ornate cast-iron fireplace forms an attractive focal point.

The adjacent snug, currently utilised as a home office, provides a more intimate yet equally versatile reception space. An impressive inglenook fireplace with a woodburning stove forms a natural focal point, while exposed beams and views across the surrounding landscape reinforce the property's rural character.



Forming the heart of the house, the impressive kitchen, dining and living area is a superb open-plan space designed for modern family life. The contemporary kitchen is fitted with sleek gloss cabinetry, integrated appliances and a central island, while generous areas for dining and informal seating create a highly sociable environment. A substantial stone inglenook fireplace with a woodburning stove provides a striking focal point and reinforces the farmhouse character of the room. Large windows draw in natural light and frame attractive views across the gardens, while the adjoining conservatory offers a further seating area from which to enjoy the south-facing aspect and uninterrupted countryside beyond.

A separate dining room opens directly onto the terrace and gardens, offering an excellent setting for larger gatherings and entertaining. A practical utility room, boot room and cloakroom complete the ground floor accommodation. Accessed from the dining room, the boot room benefits from an external door, providing a useful everyday entrance and a practical space for muddy boots, outdoor clothing and country pursuits.

The bedroom accommodation is thoughtfully arranged. The principal suite benefits from a dressing room and en-suite bathroom, while two further double bedrooms are served by a Jack and Jill bathroom. Two additional double bedrooms complete the accommodation, one enjoying the benefit of an en-suite shower room, while the other is served by a spacious family bathroom.



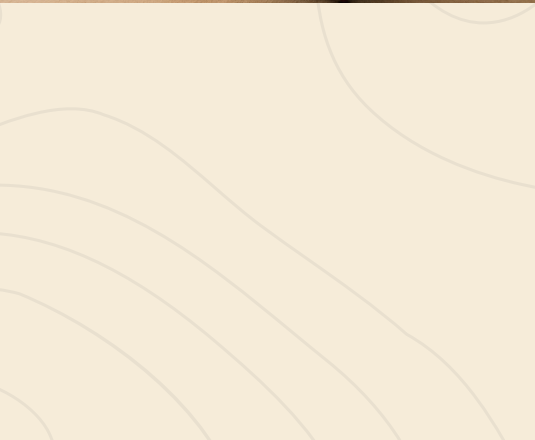

Google Maps

what3words



///audit.hockey.defensive

## Wayleaves, Easements & Rights of Way

The property is being sold subject to all existing wayleaves, easements and rights of way, whether or not specified within the sales particulars.

## Services

Mains electricity and water are connected. Air source heating provides central heating and hot water. Drainage is via a private septic tank.

Postcode Council Tax EPC Tenure

NE47 8JE

Band E

Rating C

Freehold

# Floor Plans

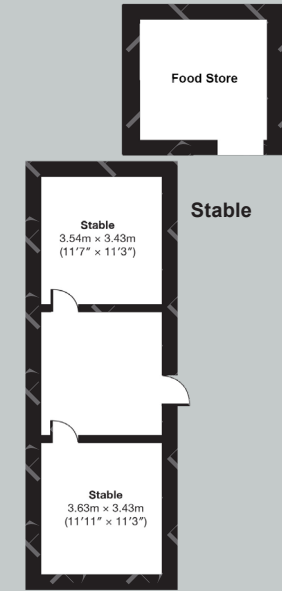

**Total area: approx. 401.3 sq. metres (4319 sq. feet)**

# Finest

Viewings Strictly by Appointment



[finest.co.uk](http://finest.co.uk)

15 Market Place | Corbridge | Northumberland | NE45 5AW  
0330 111 2266 | [contact@finest.co.uk](mailto:contact@finest.co.uk)

**IMPORTANT INFORMATION** Finest Properties, for themselves and for the Vendors and Lessors of this property whose Agents they are give notice that: (1) The particulars are set out as a general outline only for the guidance of intended purchasers or lessees and do not constitute, nor constitute part of, an offer or contract; (2) All descriptions, dimensions, reference to condition and necessary permissions for use and occupation and other details are given without responsibility and any intending purchasers or tenants should not rely on them as statements or representations of fact, but must satisfy themselves by inspection or otherwise as to the correctness of each of them; (3) No person in the employment of Finest Properties, has any authority to make or give any representation or warranty whatever in relation to this property.